

微電腦自動餵食器

CS031

MICOM AUTO FEEDER

說明書/保證書
DIRECTIONS/WARRANTY

特點

1. 單晶片微電腦控制，操作最簡便。
2. 可設12.24.48.3.4.6.8小時餵料及貯料容器轉動1.2.3圈數。
3. 防潮加熱裝置，使飼料常保乾燥。
4. 適用薄片、顆粒或冷凍乾燥飼料。
5. 夜間給料與否感光功能。
6. 可放置100公克的飼料量。

Features

1. Micro-computer with single-chip controlled. Simply operate.
2. Feeding every 12.24.48.3.4.6.8 hour & set the drum 1.2.3 rotation.
3. Wet-proof with heating installation for keeping feed dry.
4. Suited for dispensing flakes, pellets or freeze-dried treats.
5. Switch-off light sensor stops feeding in the dark.
6. Giant drum 100 grams.

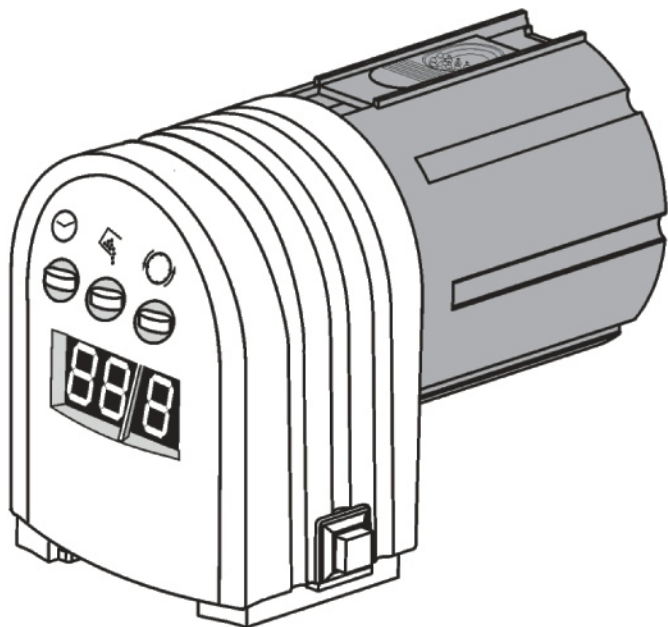

親愛的客戶：
感謝您購買本產品，為安全使用
和取得最佳性能，請詳細閱讀下
列說明：

Dear customer:
We appreciate you purchase this product,
in order to ensure your safety and gain
the perfect functions, please read
the following illustration.

注意事項

- 請勿使本體落入水中，以免電子零件短路受損。

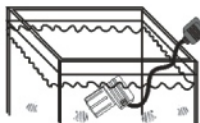

- 按鍵之正確操作方法如左圖：
壓住外殼後，再以大拇指壓按鍵。



- 避免整流變壓器的電線受到刮傷凹折，尤其是電線尾端針頭處。



- 請勿將整流變壓器的電線纏繞在其他物體上。

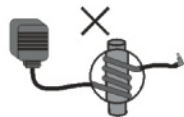

附件

- 雙面膠帶-2片



- 彈簧夾-1個



- 整流變壓器-1組

輸入：詳見標示貼紙

輸出：dc 9V 300mA



CAUTION

- Please avoid of the main-body falling into the water, and to damage the electronic components causing short.

- The proper operation of push-button as left: Pressing down the shell then press the push-button by thumb.

- Avoiding the wire of adapter being scraped, especially the pinpoint on the end of wire.

- Don't tie the wire of the adapter on other articles.

ACCESSORIES

- Double-sided tape-2 Pcs

- Spring clip-1 Pc

- ac adapter-1 set

Input: Look at mark label

Output: dc 9V 300mA



各部名稱簡介

PARTS NAMES

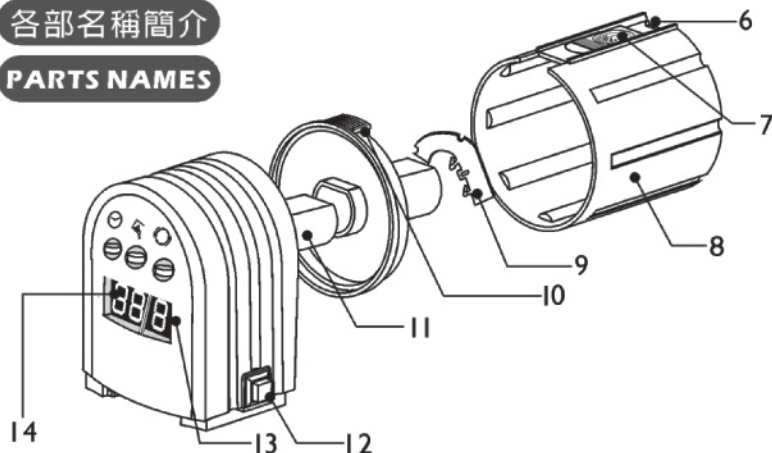

1. 貯料容器轉動次數設定鍵
2. 強迫餵食鍵
3. 時間設定鍵
4. dc 9V電源插座
5. 感光位置
6. 出料口
7. 料口調整鍵
8. 貯料容器
9. 導料片
10. 貯料容器蓋
11. 加熱器本體
12. 夜間餵食設定按鍵
13. 貯料容器轉動次數顯示器
14. 時間顯示器

1. Rotation-setting key of drum
2. Forcing feeding key
3. Time-setting key
4. dc 9V power outlet
5. Light sensor
6. Feeding window
7. Adjusting key
8. Drum
9. Transmitting sheet
10. Cover
11. Main body of heating
12. Night feeding switch
13. Display of turning times
14. Time-setting display

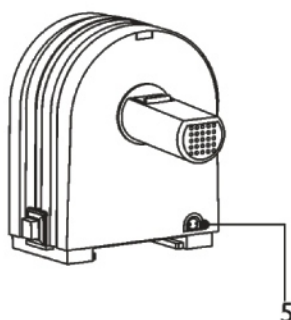
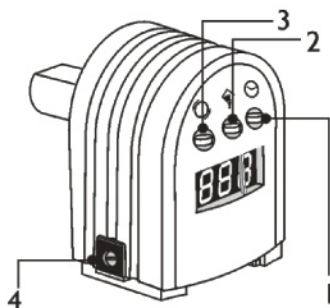

安裝在魚缸上

INSTALLING ON THE TANK

(方法一)

- 先將雙面膠帶的一面離形紙撕開後，黏貼於餵食器本體底部。
- 再將另面離形紙撕開後，將餵食器固定於魚缸上方適當的平台處以防滑動。
(注意！高度位置：以防止魚兒爭食飼料時，水滴濺起落在貯料容器內為原則。)

(Method I)

- Peel the double-sided tape off, Adhere on the bottom of main body.
- Tearing the other side of protective paper off the tape. Afterwards, install the main body of feeder the proper platform on the top of tank to avoid the main body being slipped.

(方法二)

- 將內附之彈簧夾安裝於餵食器本體腳座後，夾於魚缸上方平台，平台適用厚度為3毫米至12毫米。

(Method II)

- Attached spring clip could clip the feeder on the platform, the suitable thickness of platform is 3mm-12mm.

電源操作

POWER OPERATION

- 整流變壓器插入ac電壓插座，輸出端插入dc 9V插座。

- Plug the ac adapter into the outlet, plug the output into dc 9V plug-set.

- LED先顯示 **000**，同時貯料容器會自動轉動而定位，之後LED將顯示 **12/1** (此表示每隔12小時貯料容器會自動轉動1次)。

- The LED would be indicated **000** first, in the meantime, the drum would be turned automatically, and then located on the right place. After above action, the LED would be indicated **12/1** (It means the drum would be one rotation every 12 hours).

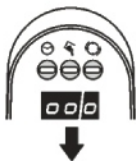
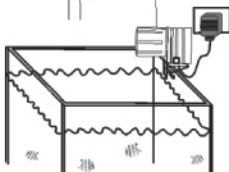
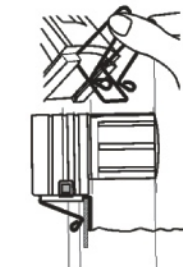
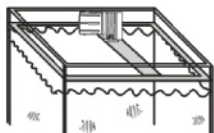
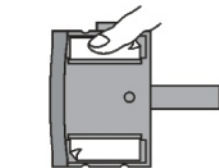

飼料裝入



- 取下貯料容器，將飼料倒入約2/3高度(勿過滿)，蓋子裝好後，再將它嵌在加熱器本體上。

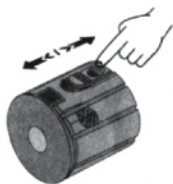

- 調整出料口大小，以決定餵食量多寡。

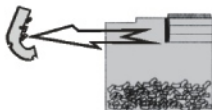

- 欲裝薄片飼料時，請將導料片拿出。

FILLING FEED

- Fetching the drum out, and then filling the feed into the drum for about 2/3 height (Don't over-filled). After locating the cover, inlaying the drum on the main body of heater.

- The feeding volume will be decided by operating the feed-adjusted key.

- While filling the flake feed, please take transmitting sheet out.

設定鍵操作

- 欲設定給料時間請按⊖鍵，每按一下，LED將從12→24→48→3→4→6→8等循環指示。LED顯示24表示從按⊖鍵動作開始24小時後，貯料容器會開始轉動以便供給魚兒飼料，往後每循環24小時會自動給料運作，其他設定時間依此類推。



SETTING KEY OPERATION

- While setting the feeding time, please push the ⊖ key, The LED would be indicated 12→24→48→3→4→6→8 at one touch.
For example, if the LED indicate 24, it means from the action of push the ⊖ key till 24 hours later, the drum would be operated automatically to feed fish, afterwards, the feeding action would be operated one rotation 24 hours, and so on.



- 如需強迫給料，請按◀鍵，每按一次，貯料容器會轉動一次。

- While forcing feeding, please push ◀ key; the drum would be one rotation every one touch.

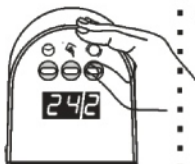

- 欲設定貯料容器轉動次數請按○鍵，每按一下，LED將從1→2→3等循環指示。LED顯示2，表示設定時間一到，貯料容器會自動轉2圈，依此類推。

- While setting the rotation, please push the ○ key. The LED would be cyclic indicated 1→2→3 at one touch. For example, if the LED show 2, it means while reaching the setting time, the drum would be two rotation, and so forth.

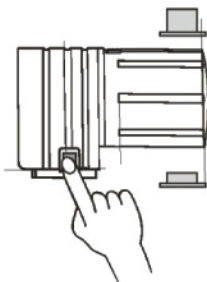

- 如夜晚(光線不足)不需餵食，請押出開關。

- Push the switch out while not feeding in the night(weak light).

- 夜晚(光線不足)需餵食，請押入開關。

- Push the switch in while feeding in the night(weak light).

技術規格

TECHNOLOGICAL SPECIFICATION

●機型:CS031A

●電源:整流變壓器

輸入:詳見標示貼紙

輸出:dc 9V 300mA



●加熱器消耗功率:1W

●夜間感光功能:
光敏電阻CdS

●縮短時間測試:

I.以小起子(外徑小於1毫米)
穿過針孔,壓下觸摸開
關。

II.LED設定48/1

III.每隔48秒後,貯料容器
會自動旋轉一圈。

IV.再壓觸摸開關則停止
縮短時間測試。

●飼料容量:100公克

●尺寸(寬x高x深):

85x108x160毫米

●重量:600公克

●注意:

●上列數據皆為近似值,
規格若有變化,恕不另行
通知。

●Model:CS031A

●Power: ac adapter

Input: Look at mark label

Output: dc 9V 300mA



●Heater Wattage:1W

●Luminous sensor function: CdS

To shorten the testing time:

I.Using a screw driver(OD below
1 mm) to through the pinhole and
then push down the touching switch.

II.The LED must be set at 48/1.

III.The drum would be one rotation
every 48 seconds .

IV.Push down the touching switch
again,and it would be shortened
the testing time.

Feed capacity:100g

Measurement(WxHxD):

85x108x160mm

Weight:600g

ATTENTION:

Above data is only approximate,
it wouldn't be advised if
the specification being changed.

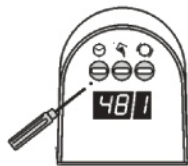

保 證 卡

1. 在正常使用下，如發生故障，自購買日起保證一年，換修材料免費。
2. 因使用錯誤，導致故障，需換零件時，應繳付材料費。
3. 如故障請送原經銷店。
4. 本卡無購買日期或未蓋經銷售店章者無效。

GUARANTEE

THIS PRODUCT IS WARRANTED FOR ONE YEAR FROM THE DATE OF PURCHASE AGAINST ELECTRICAL & MECHANICAL & DEFECTS IN MATERIAL & WORKMANSHIP.

IF FOR ANY REASON THIS APPLIANCE SHOULD NOT OPERATE SATISFACTORILY, TEST THE SOCKET WHICH THIS APPLIANCE HAS BEEN CONNECTED TO WITH ANOTHER APPLIANCE.

ALSO MAKE SURE THE PRONGS OF PLUG ON APPLIANCE ARE IN GOOD CONTACT WITH THE WALL OUTLET. IF YOU ARE SURE THE APPLIANCE IS DEFECTIVE. RETURN IT, TO APPLIANCE SERVICE STATION, FOR REPAIR OR REPLACEMENT WITHOUT CHARGE AT THE MANUFACTURER'S OPTION.

IF REPAIRS ARE NECESSARY AFTER GUARANTEE PERIOD A NOMINAL CHARGE WILL BE MADE.

DAMAGE TO APPLIANCE BY REASON OF ABUSE OR TAMPERING IS NOT COVERED BY THIS GUARANTEE. THIS GUARANTEE DOES NOT INCLUDE THE INSIDE OR OUTSIDE COVERING. WITH PROPER CARE THE COVERINGS SHOULD LAST INDEFINITELY.

購 買 日 期 _____/_____/_____

Date of Purchase _____/_____/_____

經 銷 店 章

Store of Purchase