

THRU-WALL LEVEL ALARM 穿牆式液位警報器 說明書

TYPE SPECIFICATION

Lo level with signal output and alarm CS093-1-L

型號規格

低液位信號輸出與警報

FEATURES

1. This is a capacitive sensor, Microcontroller Unit detects different dielectric constant of the non-conductive glass or plastic vessel and liquid, on which taking its change of capacitance to position the Low liquid level.
2. Pressing housing to set the liquid level.
3. Alarm & Color the liquid level.

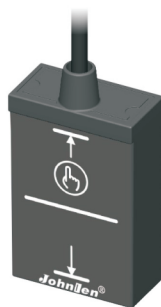

特點

1. 這是一種電容式感測器，微控制器檢測不同介電常數之玻璃、塑膠等非導電容器和液體，取其電容變化而將低液位定位。
2. 按壓外殼即可設定液位。
3. 警報和顏色指示液位。

TECHNICAL SPECIFICATIONS

Dimensions (LxWxH)	35.3x17.9x64.6mm	尺寸(長X寬X高)
Supply voltage	7~24VDC	供電電源
Current supply (Enable alarm)	90mA Max	電流供應(警報器動作)
Switching current	3.3~40mA	開關電流
Maximum switching frequency	1Hz	最大開關頻率
Ambient temperature range	-15~+60°C	環境溫度
Thickness of the vessel wall	2~15mm	容器厚度
Protection class	IP 64	防護等級

The use of the alarm which is paired up micom liquid feeder is only reminding that the liquid will be running out, these things of which does not directly affect the operation of micom liquid feeder, the alarm and micom liquid feeder operate independently, only the power sharing, if the alarm do not need to use that can remove it.

警報器搭配微電腦自動加液器的用途僅為提醒液體即將用完，並不會直接影響自動加液器的運作，警報器與自動加液器各自獨立運作，只有電源共用，如不用警報器時可將其拔除。

INSTALLATION FOR ALARM

警報器安裝

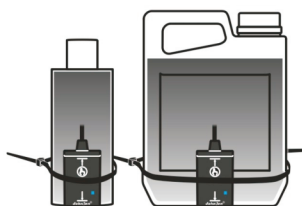

1. Fix the alarm on the bottom side of the outer wall of the plastic vessel.

1. 將警報器安裝在塑膠容器外壁之底側。

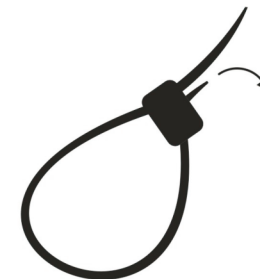
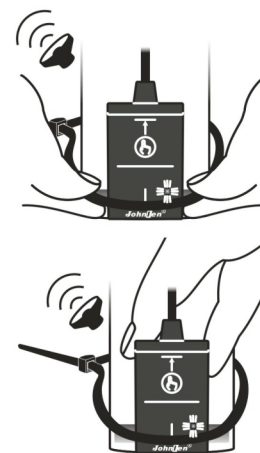
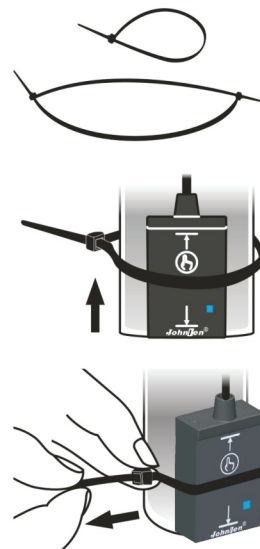

2. Attachment is done by tying a cable tie.
- Steps of tying the cable tie as follows:
 - 2-1. The pointed tip of the cable tie be pulling through the open case that build a loop.
 - 2-2. Put the vessel and the alarm together and then take this loop in the upward direction from the bottom of the two objects to tighten the two objects up (the cable tie placed about midline position).
 - 2-3. Depress the open case up and down by the two fingers, the other two fingers pull the cable tie out so that the alarm can be fastened and positioned.

3. Replace the new liquid:
 - 3-1. Depress the cable tie down.
 - 3-2. Remove the alarm up.
 - 3-3. A tab be depressed to release the ratchet so that the tie can be reused.
 - 3-4. As 2-1 ~ 2-3 steps replace the new liquid.

2. 附著是由繫線帶綁緊完成。
- 綁繫線帶步驟如下：
 - 2-1. 將繫線帶之尖窄端穿入開口端成一環圈。
 - 2-2. 將容器與警報器併靠在一起後拿此環圈從二物件之底部往上之方向將此二物件套緊（繫線帶置放於約中線位置）。
 - 2-3. 二指上下按壓開口端，另二指將繫線帶往外拉，如此可將警報器鉗緊並定位。

3. 換新的液體：
 - 3-1. 將繫線帶下壓。
 - 3-2. 往上取出警報器。
 - 3-3. 按壓突片將棘輪釋放使得繫線帶可被重複使用。
 - 3-4. 如2-1~2-3步驟換成新的液體。

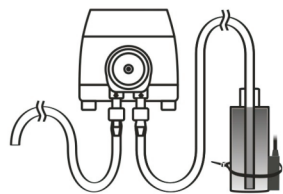

THE ALARM BE USED WITH A LIQUID FEEDER

1. The entrance tube be sure to touch the bottom of the plastic vessel.



2. Press button so that both side of tube be full of liquid.

Attention:

Exchange the new liquid, this procedure must do.

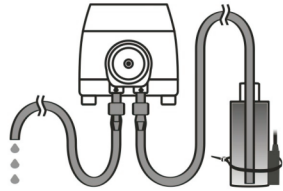

3. Plug the dc plug of the alarm into the dc12v jack of the liquid feeder.

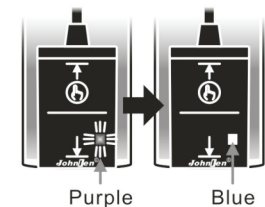
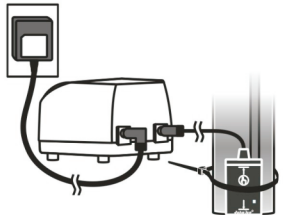

4. The alarm be enabled, the LED flashes with purple color 8 times, then it skip to blue color, it means that the liquid inside the vessel will be at least half (50%) or more.

Attention:

Each new bottle, the liquid inside the vessel will be at least half full.



5. LO level settings:

- 5-1. Press button about 2 seconds, then the LED flashes with blue color.

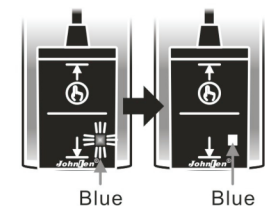

- 5-2. Left button, the LED flashes with blue color about 10 times, then skip to blue color.

警報器配合加液器使用

1. 進料管務必接觸到塑膠容器底部。

2. 按 鍵使左右兩邊管子佈滿液體。

注意：

換新液體時，此道程序必做。

3. 將警報器的dc插頭插入加液器的dc12v插座內。

4. 警報器通電，LED閃爍紫色8次後跳至藍色，此表示容器內的液體是至少有一半(50%)以上。

注意：

每換新瓶，容器內的液量至少需半滿。

5. 設定低水位：

- 5-1. 按 鍵約2秒後LED會閃爍藍色。

- 5-2. 離開 鍵LED會閃爍藍色約10次再跳至藍色。

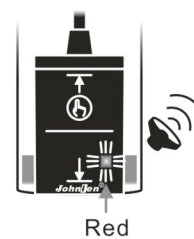
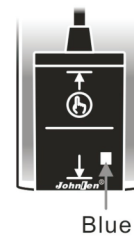

- 5-3. LED skip to blue color, it means that the low level be positioned.

6. The LED flashes with red color and sound an alarm twice, it means that the level alarm be positioned in low level state or placed in the air, and then will sound an alarm twice in every 6 seconds.

Attention:

1. According to the different composition and concentration of various liquid and the different material and thickness of the vessel, the alarm warning the low level will be different about from 0 to 5 cm (Special materials will be more than 5 cm) that will start flashing with red color and sounding an alarm.

2. Depending on the different speed of crystallization of each liquid, the liquid which be easier to form crystals will extend the response time of the alarm, the longest response time spend about 30 minutes before the alarm will sound an alarm.

- 5-3. LED跳至藍色，表示低水位定位完成。

6. LED閃爍紅色並警報聲2次，表示液位警報器處在低水位狀態或置於空氣中，而後每隔6秒會警報聲2次。

注意：

1. 依照各種液體成份及濃度的不同和容器材質及厚度的差異，警報器警示液體之低水位會有所不同，約介於0~5公分之間（特殊材質會大於5公分），會開始閃爍紅燈並發出警報聲。

2. 依照每種液體結晶速度不同，越容易行成結晶體之液體越會延長警報器的反應時間，最長反應時間約需30分鐘後警報器才會發出警報聲。

Johnlen®
C-BLUE CO., LTD.

www.cblue.com.tw cblue@ms4.hinet.net
TEL:+886-7-7337206 FAX:+886-7-7335594